

Please read this user manual carefully to fully understand the usage of the cordless spinning mop. Keep the manual for future reference since it contains important information.

IMPORTANT SAFETY INSTRUCTIONS

1. The product suitable for indoor use only
2. The product is suitable for cleaning the hard wood floor and tile ect., not suitable for cleaning carpets and/or uneven floor.
3. The product is suitable for cleaning small dust, waterlogging & for example sauce on floor, not suitable for cleaning big piles of dust.
4. For avoid damage on the wooden floor,can not use the scouring pad for cleaning on wooden floor.
5. Keep away from the children.
6. Discharge fully after long time operation, recharge should be carried on after 30 minutes rest, for battery protection and life-span prolong.
7. Please do not press the spray water button long time during use or when there is no water in the tank for avoid damage on the water pump.
8. Not allowed to turn on the product before install the mop.
9. Please don't touch the spin mop during working. (It can causes accidents or product problem).
10. Take off the mops, clean them and dry it after use.
11. The battery need to be taken out before disposal of this appliance.
12. The appliance must be off before take out the battery pack.
13. The battery should be disposed properly and safely.

Please ensure that the product power is switch off before cleaning and/or maintenance it.

Please clean the product gently with soft cloth with water and/ or neutral detergent.

Do not clean the product with gasoline, alcohol,lacquer thinner or strong detergent.

PART DESCRIPTION

1. Spray water button
2. Switch button
3. Handle
4. Power adaptor
5. Aluminium tube
6. Discharge LED
7. Battery capacity LED indicator
8. Upper body
9. Water tank
10. Lower body
11. Headlight
12. Side brush
13. Water sprayer
14. Spin mop
15. Rear mop
16. Dust bin

INSTALLATION OF THE SPINNING MOP

Install the handle into the aluminium tube according to the picture on the right. The Aluminum body needs to be installed in the upper body and after that the upper body needs to be installed in the lower body.

KEEP THIS INSTRUCTION MANUAL FOR REFERENCE AS IT CONTAINS IMPORTANT INFORMATION.

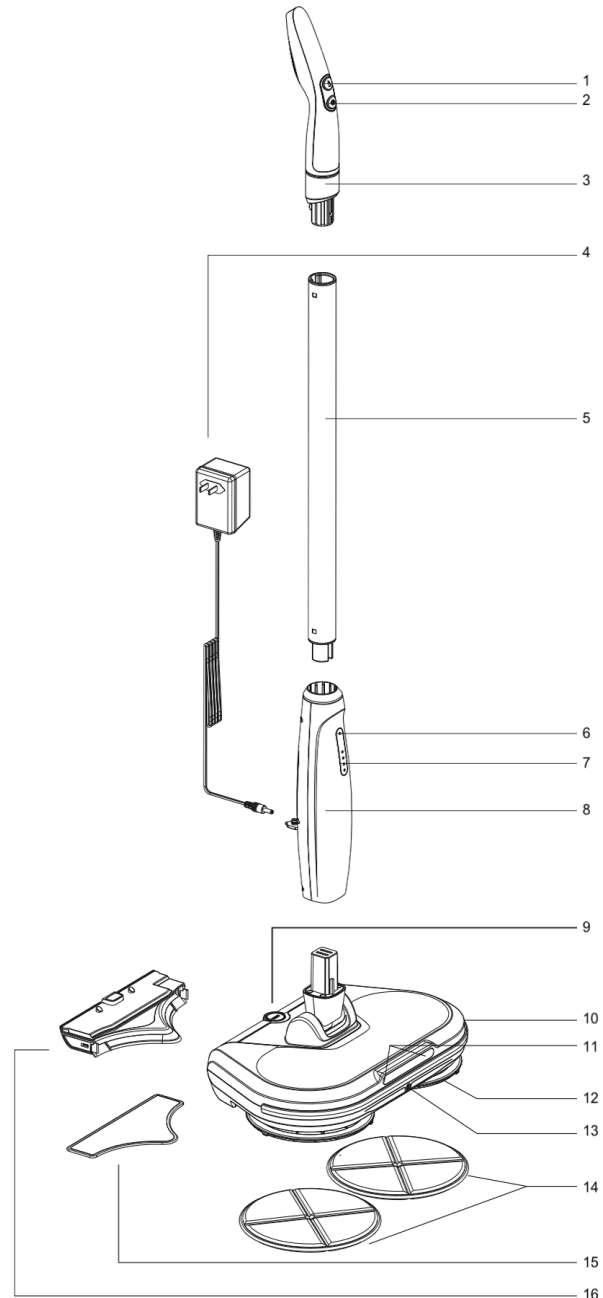

CHARGING THE SPINNING MOP

The top LED lights will start blinking when the battery is running low. Recharging is required.

1. Turn off the switch.
2. Plug the adaptor to power outlet.
3. Connect the adaptor with the spinning mop.
4. During charging the LED light will blink.
5. The battery is fully charged when all LED lights are on.

Make sure the adaptor including the wire are without damages or aging phenomenon.

Please use the original adaptor for charging.

Please avoid the charging port or adaptor from immersing in water. Please avoid charging and storing the product below 0°C and above 40°C, otherwise the product performance might be degraded. Product temperature rise is normal phenomenon during charging.

